

The Halls

NORWICH

St. Andrew's Plain in
the heart of Norwich

St Andrew's
Blackfriars'
The Crypt
The Cloisters
Beckett's Chapel



a fantastic venue for

concerts
banquets
weddings
conferences
exhibitions
fairs



NORWICH
City Council

Welcome to The Halls, Norwich



These magnificent flint buildings date from the 13th century and today, they are the most complete Friary complex surviving in this country. Since the Reformation, they have been used for a wide range of civic functions, concerts, banquets and fairs.

Today, all areas of the Halls may be hired for a variety of purposes. The main parts are **St Andrew's Hall**, the grandest space with a seated capacity of 900, **Blackfriars' Hall**, equally impressive but smaller and more intimate accommodating 350, the **Crypt** seating 50 people, **Becketts Chapel**, a semi-outdoor space and the **Cloisters**, a flexible space, long and narrow that can be extended or reduced as required.

St Andrew's Hall is a wonderful setting for many types of event from conferences and trade fairs to concerts and weddings to name just a few. There is no more prestigious place for a wedding ceremony than this magnificent hall. St Andrew's is the principal venue for the Norfolk and Norwich Festival in May each year and hosts numerous classic and jazz concerts from national and international artists throughout the calendar. The Halls also have a resident orchestra, the renowned Britten Sinfonia. Blackfriars' Hall is frequently used for meetings, conferences, elegant dinners and weddings all overseen by the portraits of illustrious civic forefathers.

The Halls are very close to the city centre, the cathedral, Elm Hill, Cinema City, the Norwich School of Art & Design and the Norwich Playhouse which all adds up to an excellent position in the heart of a very cultural area.

The Halls are not only magnificent and rich in atmosphere, they are also a practical and efficient venue. A well-stocked bar and mobile bar facilities are available for any event and should you wish to hire or bring your own caterers there is a large and fully-equipped commercial kitchen on site. The Halls team are available at every stage of your booking for advice regarding the hiring of additional materials ranging from flowers to audio-visual presentation equipment.

The Halls are perfect for private and corporate customers but are also available to the arts, community and cultural sectors at surprisingly affordable rates. If you are interested in staging your function at The Halls please contact The Halls Management Team to discuss the possibilities - they are limitless!





St Andrew's Hall

St Andrew's Hall is the centrepiece of this complex of buildings and the name by which many people refer to it. It has a fine, high-beamed ceiling, beautiful stained glass windows, limestone columns and a large polished maple floor. It was originally the nave of the Friary and was completed in 1449. The size and beauty of its proportions are impressive without elaborate decoration in keeping with the friars' rule of simplicity. The stained glass, stone carving and deeply-coloured portraits add richness to the simple backdrop of the building, adding a contemporary feel to this incredibly historical building of civic tradition - the best of both worlds.

The nave was intended as the great preaching hall for the citizens of Norwich with the pillars kept as light and as high as possible to maximise vision and acoustics. The fine hammer-beam roof was a gift from Sir Thomas Erpingham who commanded English archers at Agincourt. The west window is Victorian Gothic and contains fine examples of stained glass depicting the coats of arms of well-known local families.



The hall has traditionally been used for a multitude of functions from Royal banquets to international table tennis. It is regularly used for classical, jazz, folk and pop concerts and is a main venue for the Norfolk and Norwich Festival and the Britten Sinfonia. It is popular for banquets and dinners, conferences, collector's markets and exhibitions.

St Andrew's has a fixed stage, which can be extended, and a retractable tiered gallery which transforms it into an impressive auditorium seating 800 people. The stage and choir stalls can accommodate orchestras of 100 musicians and choirs of 250. With appropriate space management, however, it is also comfortable for much smaller groups of performers. Behind the choir stalls is the organ that was specially commissioned and designed for St Andrew's by the Bryson Brothers in 1880. There is also a Steinway grand piano which is available for hire.



The tiered seating accommodates up to 186 people and provides a fabulous arena, either directed at the permanent stage or for central arena events. Main access is through the porch door and is flat and accessible but it is also integrated with the facilities of the adjoining hall spaces.



There is disabled access throughout The Halls





Blackfriars' Hall

This lofty, oak panelled hall adds style and elegance to any event. Around its walls are paintings dating from the 16th century, of mayors, sheriffs and benefactors to the city forming an important part of the civic portrait collection. The most impressive is a large portrait of Admiral Lord Nelson, the last ever painted, by James Beechy, who was a friend of Nelson and a member of the Royal Academy. The pictures and the decor add a tremendous sense of occasion and history to any event, as appropriate to a conference or book launch as to a wedding or banquet.

At the east end of the hall is a seven light window dating from the mid-14th century. The hall was named after the Black Friars, a chapter of the Dominican order known for their black habit, which was established in Norwich in 1226. They built the Friary in 1345, largely funded by bequests from the citizens of Norwich as the friars lived in relative poverty as part of their beliefs.

Today, the hall can accommodate up to 250 diners for a formal banquet or 370 for a wedding ceremony and reception, concert or meeting. At the east end is a raised stage and for smaller events the hall can be realigned with a smaller stage on the north side to create a more intimate atmosphere.

The entrance to Blackfriars' Hall is either through the east porch door or via the rest of The Halls complex. There are steps up to the hall with a lift for easy wheelchair access. A public address system is available for speech reinforcement, and an induction loop fitted for those with hearing difficulties. There are power, microphone and input sockets around the hall as well as 63amp three phase supply and further presentation equipment can be hired to suit the event.

Blackfriars' Hall has a Brimsmead upright piano stored on stage which can be hired for use during any event.

As well as being a practical and elegant venue in its own right, Blackfriars' Hall is an ideal reception space or sponsor's lounge for larger events that are taking place in St. Andrew's Hall.

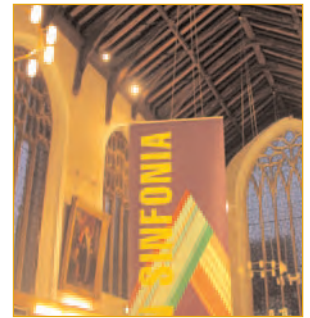

Did you know that this is one of the last portraits of Admiral Nelson, painted by James Beechy in 1802, three years before Nelson died?

The Crypt, the Chapel...

This is the oldest part of the building and was built around 1258 as a simple unvaulted chamber, probably as the friars' dormitory. The washing place is still there to be seen near the doorway to the Beckett's Chapel. The most amazing feature now is the brick vaulted ceiling which, with controlled lighting, creates an unusual and intimate atmosphere, quite different to the other spaces of the Halls. This lower ground room is small and cosy and makes an inviting setting for an evening function of up to 60 people. By using the adjoining areas this can be extended to 150 people. Recent events have included wine tastings, product launches, comedy evenings and reception parties. It is an unusual location for a private party, served by the bar upstairs or from the mini bar downstairs.

During the summer, the doors open onto the Thomas A' Beckett Chapel, a semi-outdoor area which has the original ruined chapel walls covered by a modern transparent roof. With natural plant growth decorating the walls, effective outdoor heating and lighting by candles this is an intriguing social space. The area can be equipped with a stage and lighting rig and used for theatre performances to great and unusual effect.

In the daytime, the Crypt is a café, open from 8am to 4.30pm and serving breakfast, lunch and snacks. Run by inhouse caterers it offers a range of high quality food and beverages, making it a great meeting place all year round.

Access to the Crypt is from the reception area down a short flight of stairs or from St Andrew's Hall, which has a chair lift as well as steps, and entering via the Cloisters. The three areas, the Cloisters, Crypt and Chapel flow into one another and can be used as a continuous space or in sections.

...and the Cloisters

This versatile space is what remains of the original quadrangle, around which the friars would have studied and meditated. Best known for being the weekly venue for the lively antiques market, the Cloisters can be used as a gallery for exhibitions, trade fairs and as an overspill area for larger events in the main halls.

It can accommodate sizeable gatherings but can also be shortened into smaller sections for a more intimate atmosphere. In the summer, the doors can be opened out into the grassed quadrangle of the Garth. This large and attractive space is ideal for siting a marquee which can be arranged via The Halls Team.



Conferences, meetings, workshops, training...

...awards ceremonies, briefings and more. On the first floor of the complex there is a set of rooms suitable for business and corporate use such as meetings and conferences.

The two biggest rooms, 'Erpingham' and 'Paston', are suitable for meetings, lectures and similar gatherings. These well-furnished rooms can accommodate up to 15 people in a boardroom setting and up to 25 people in lecture or classroom-type groups. A range of extra equipment is available including flipcharts and projection screens. Refreshments can be provided throughout the hire.

The smaller rooms, 'Buxton' and 'Walpole', are ideal for use as dressing, consulting or interview rooms. They have ensuite toilet and washing facilities which makes them useful as a place for some types of therapy sessions. The set of rooms together offer flexible provision for a variety of business and corporate uses.

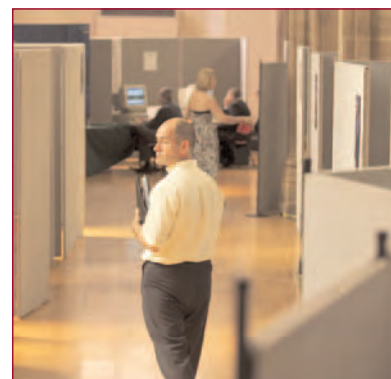
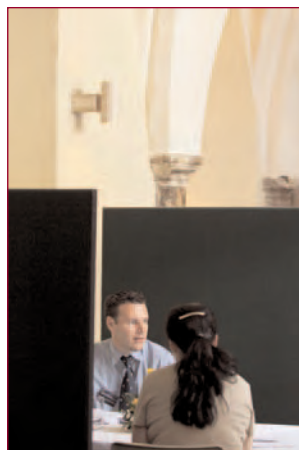

Catering for events

Nelson's Bar

The fully licenced bar at The Halls is managed in-house and is available to provide a complete service for all functions booked at The Halls. In addition we offer a comprehensive wine list with a range designed to fit any budget.

Kitchen

The in-house caterers in the Crypt provide an excellent service throughout the week to all the visitors to The Halls. In addition, they are able to provide menus and quotes for any event being run at The Halls.

Alternatively, your own caterers can use the fully-equipped catering standard kitchen by arrangement.



By the way, The Halls are non-smoking throughout



Technical specifications at a glance

St Andrew's Hall

Dimensions

Floor	95' x 70' or 29m x 21.5m
Permanent stage	40' wide by 17' deep, apron, no proscenium
Extensions	5 units 8' x 6' plus 2 units 8' x 4'
Height	Approx 65' in central aisle, 45' in side aisles
Lighting	Stage – 32 x 1kw plus 2 x 2kw follow spots controlled by Strand MX 48 way board Auditorium – 15 chandeliers dimming control plus clerestory window lights, picture spots and pillar uplights. No blackout possible

Accommodation	maximum	optimum	effective minimum
Theatre-style	900	829	200
Concert plan 3	829	740	550
Concert plan 4	789	700	530
Dinner	600	500	250
Dinner Dance	500	450	100
Fashion show	800	600	300
Sales events 6' tables	80	70	
8' tables	65	55	



Blackfriars' Hall

Floor	29' 9" x 81' 6" or 9.05m x 24.90m
Permanent stage	31' wide by 17' 9" or 9.45m x 5.45
Extensions	5 units 8' x 6' plus 2 units 8' x 4'
Height	Approx 60' i or 18.3m
Lighting	Stage – 32 x 1kw plus 2 x 2kw follow spots controlled by Strand MX 48 way board Auditorium – 15 chandeliers dimming control plus clerestory window lights, picture spots and pillar uplights. No blackout possible

Accommodation	maximum	optimum	effective minimum
Theatre-style	370	300	100
Side stage	350	200	30
Dinner	250	200	50
Dinner Dance	200	150	75
Fashion show	370	300	100
Sales events 6' tables	40	35	
8' tables	30	25	

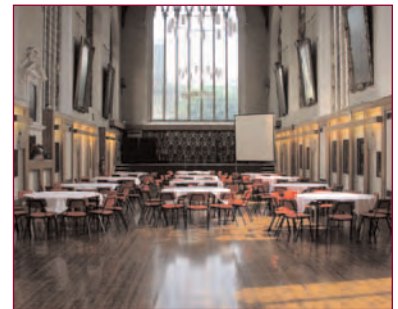

Layout of the ground floor of The Halls

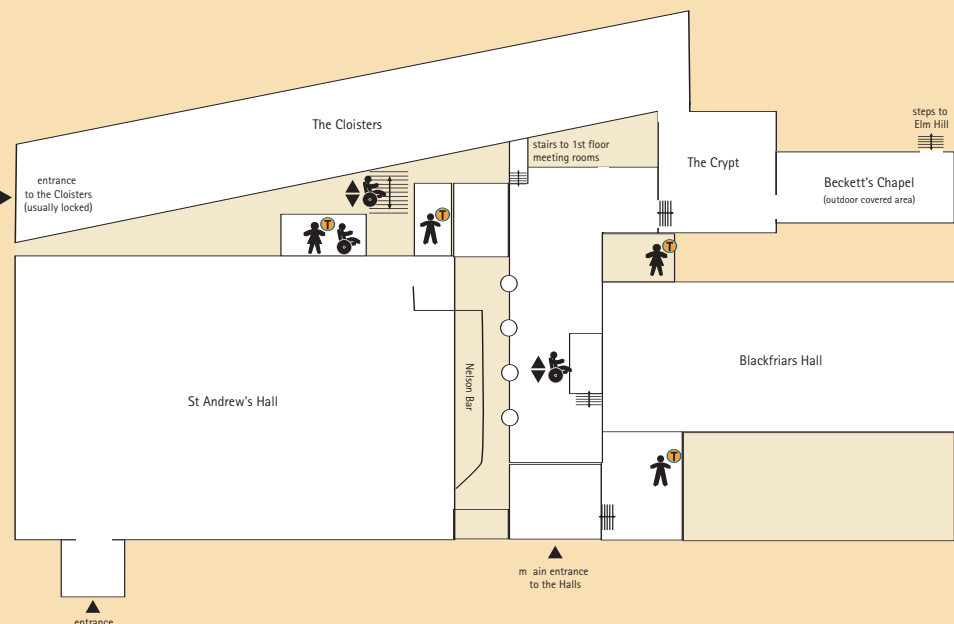



The Halls NORWICH

Where to find The Halls in Norwich

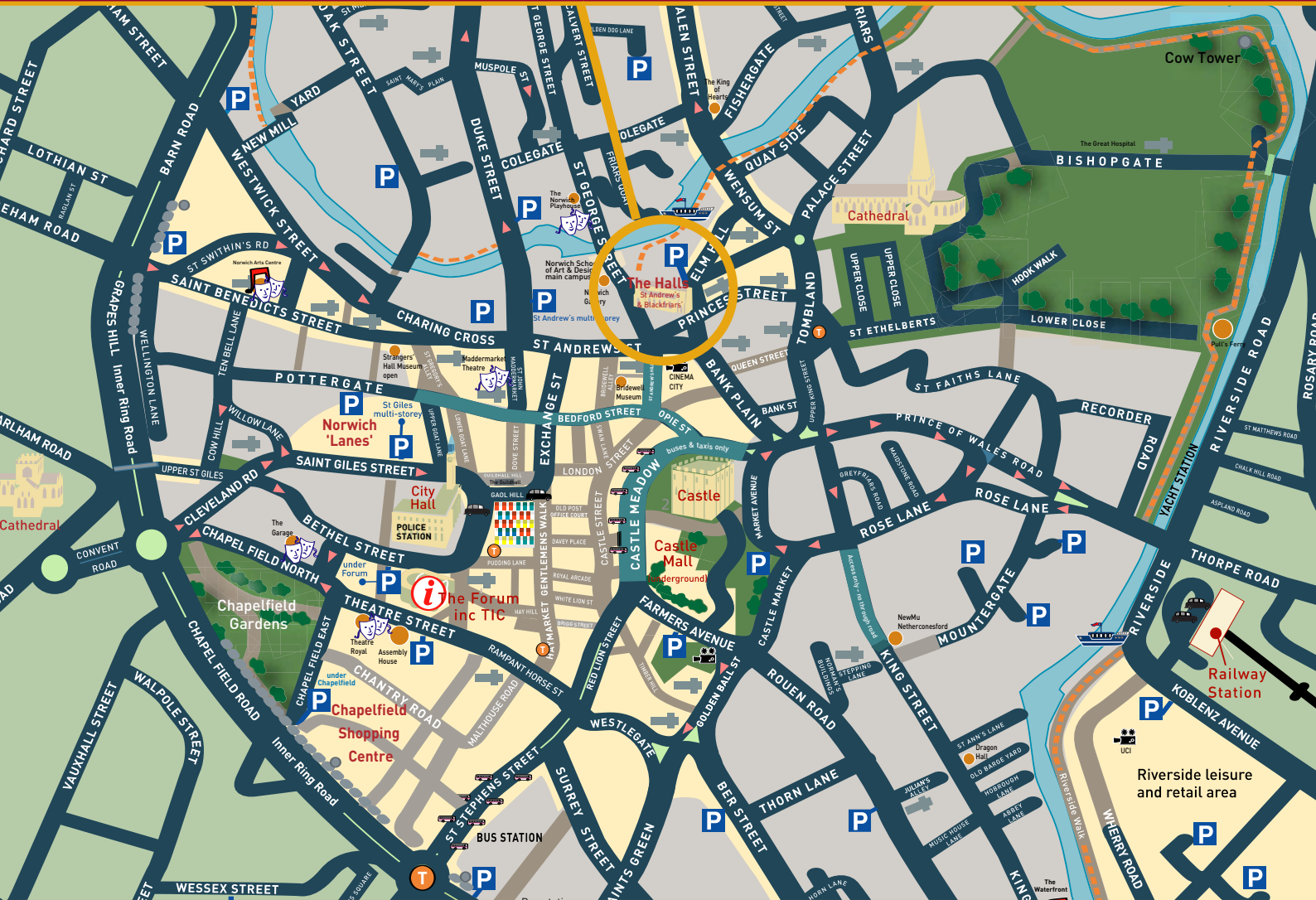

Where to park

There is parking nearby at the Monastery pay-and-display car park behind the Halls, off Elm Hill and at the newly built St Andrew's multi-storey car park with its entrance on Duke Street. Not far away is the Colegate pay-and-display. For deliveries, please call The Halls Team.

Visitors are welcome although please note that access is sometimes restricted when there is a private event.

To discuss hire or arrange a visit please contact The Halls Management Team on 01603 628477 or at The Halls, St Andrew's Plain, Norwich NR3 1AU.
Email: thehalls@norwich.gov.uk
Web address: www.standreshall.co.uk

A fantastic venue for

concerts
banquets
weddings
conferences
exhibitions
fairs



NORWICH
City Council

The Halls are owned and managed by Norwich City Council